

# ORILLIA CAMPUS FIRST FLOOR

- Bear Essentials Bookstore (A102)
- Elevators ↓↑
- Main entrance

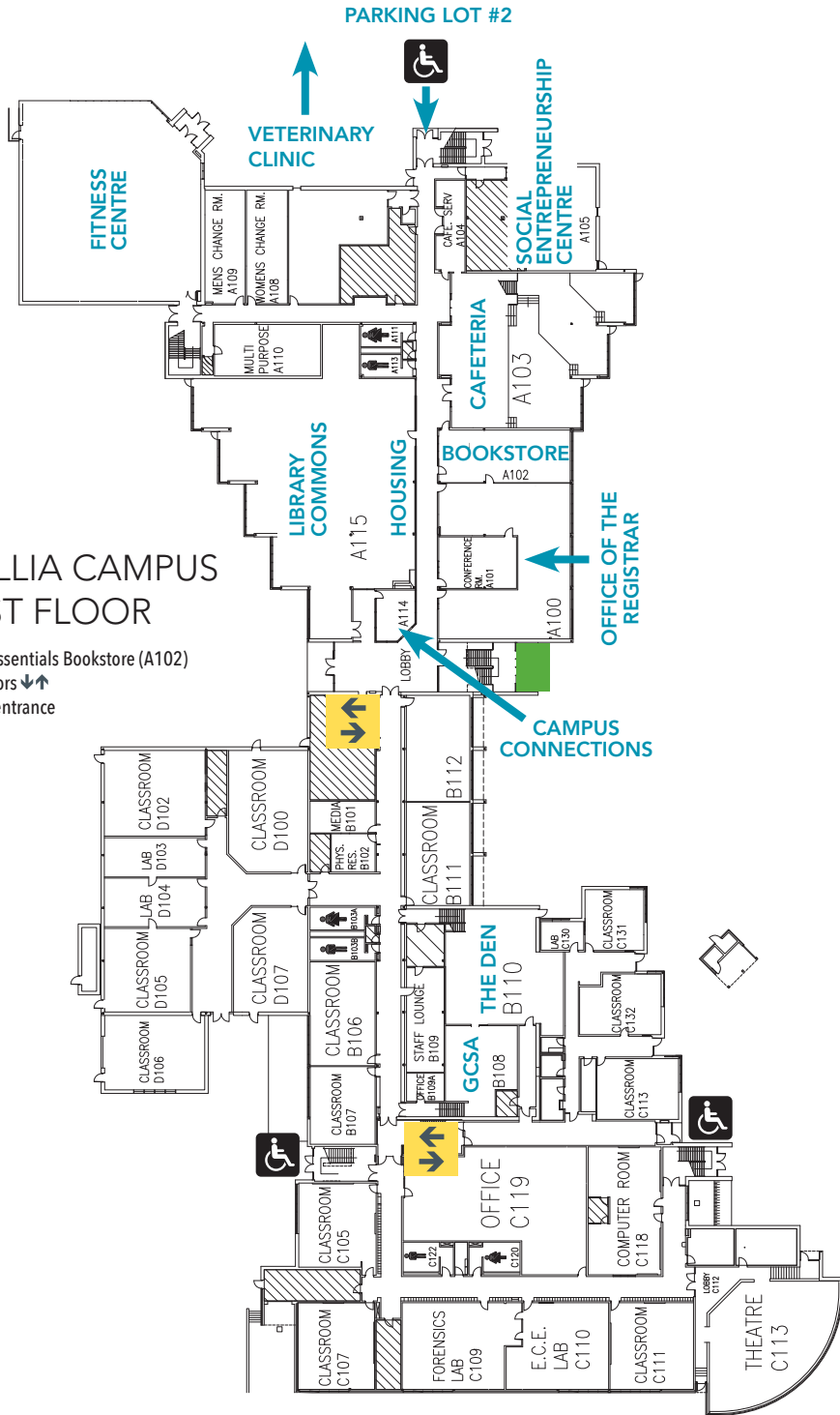

# ORILLIA CAMPUS SECOND FLOOR

- Career and Employment Community Services/Academic Upgrading (A201)
- Student Success Services (A200)
  - Testing Services
  - Counselling Services
  - Accessibility
  - Adaptive Technology
  - Academic Success Centre (Learning Strategists/Peer Services)
  - Transition and Engagement
    - First Year Experience
    - First Generation Experience
    - Crown Ward/Transition Advisor
    - Co-operative Education and Career Success
- Georgian College Students' Association (GCSA) (B108)
- Elevators ↓↑
- Main entrance

